



SINCE 1909
JAPAN

2019 | 2020

1st Edition



110TH ANNIVERSARY



Contents

- 01 Ceiling Fans
- 13 Wall Fans
- 15 Auto Fan
- 16 Glass Mounted Ventilating Fans
- 17 Wall Mounted Ventilating Fans
- 20 Ceiling Mounted Ventilating Fans
- 21 Ceiling Mounted Sirocco Ventilating Fans
- 25 Industrial Ventilating Fans
- 26 High Pressure Industrial Ventilating Fans
- 29 Industrial Wall Fans
- 31 Air Curtains
- 33 Mini Sirocco Fans
- 35 Accessories

Safety Features For Ceiling Fans



Safety Wire

Safety Wire secures the fan motor to the ceiling hook.



Cut-off Safety Switch

Cut off power supply while detecting dangerous wear and tear of the shaft or bolt.



Blade Safety Wire

(applicable to model: K12W0, K15W0, K15W0-S and K15W0-SL)

In the event of breakage of the blade frame, the Blade Safety Wire will hold the blade to the motor.



Blade Safety Hanger

(applicable to model: K12V0, K15V0 and K15V0-PBR)

In the event of breakage of the blade frame, the Blade Safety Hanger will hold the blade to the motor.



Indoor Air Problems in Your House

What are the Indoor Air Quality problems existing in your house?

Recently, many reports show that people are in poorer physical condition. It is because of high living density and usage of building or interior material which emit chemical substances in either new-built or reformed house, causing indoor air quality problems.

There are different symptoms, such as eyes/throat sore, nausea, feeling unwell, skin irritation, headache, dizziness, breathing problem and so on. Furthermore, chemical substances like formaldehyde, can lead to the deterioration of allergic illness.



1

Beware of Curtain, Sofa and Any Other Furniture you brought in

Chemical substances are also released from curtain, sofa and any other furniture you brought in.



2

Wall and Flooring which Occupied the Most Area, are Big Enemy of Clean Air

Materials like adhesive used on wall and/or flooring, will keep on releasing chemical substances in long period of time.



3

Fabric Sofa and Stuffed Doll

Scurf and dander from human beings and pets are the favorites of mites. Thus, it is important to be cautious with fabric sofa and stuffed doll.



4

Even Flooring Need to pay attention

Though natural-material-made flooring looks safe, chemical substances like gloss wax may still be emitted.



5

Kitchen with Lots of Water Vapor is the Food Storage for Mold

Water vapor is created when gas is being burnt. Also the dirt after cooking provides nutrition for mold.



6

Floor and Bathroom Sink are good places for Termite to Inhabit

High humidity of bathroom (especially the floor), provides good places for termite to inhabit.



7

Bathroom with Heavy Amount of Water Vapor is the Wonderland for Mold

Heavy amount of water vapor can be produced in a short period of time. Wall, flooring & ceiling of bathroom are made by moisture-proof materials and thus high temperature is maintained. Please clean your bathroom without leaving any soap residue.



Way To Improve Indoor Air Quality

The first step to improve indoor air quality should be to reduce or remove the source of the pollutants. Unfortunately, indoor pollutants are virtually impossible to eliminate completely, creating the need for a second step - ventilation. Ventilation is divided into “Natural Ventilation” and “Mechanical Ventilation”.

Natural ventilation is neither consistent nor reliable since it relies heavily on wind and weather conditions. Mechanical ventilation removes stale, moist, polluted air and replaces it with fresh outside air by using a fan.

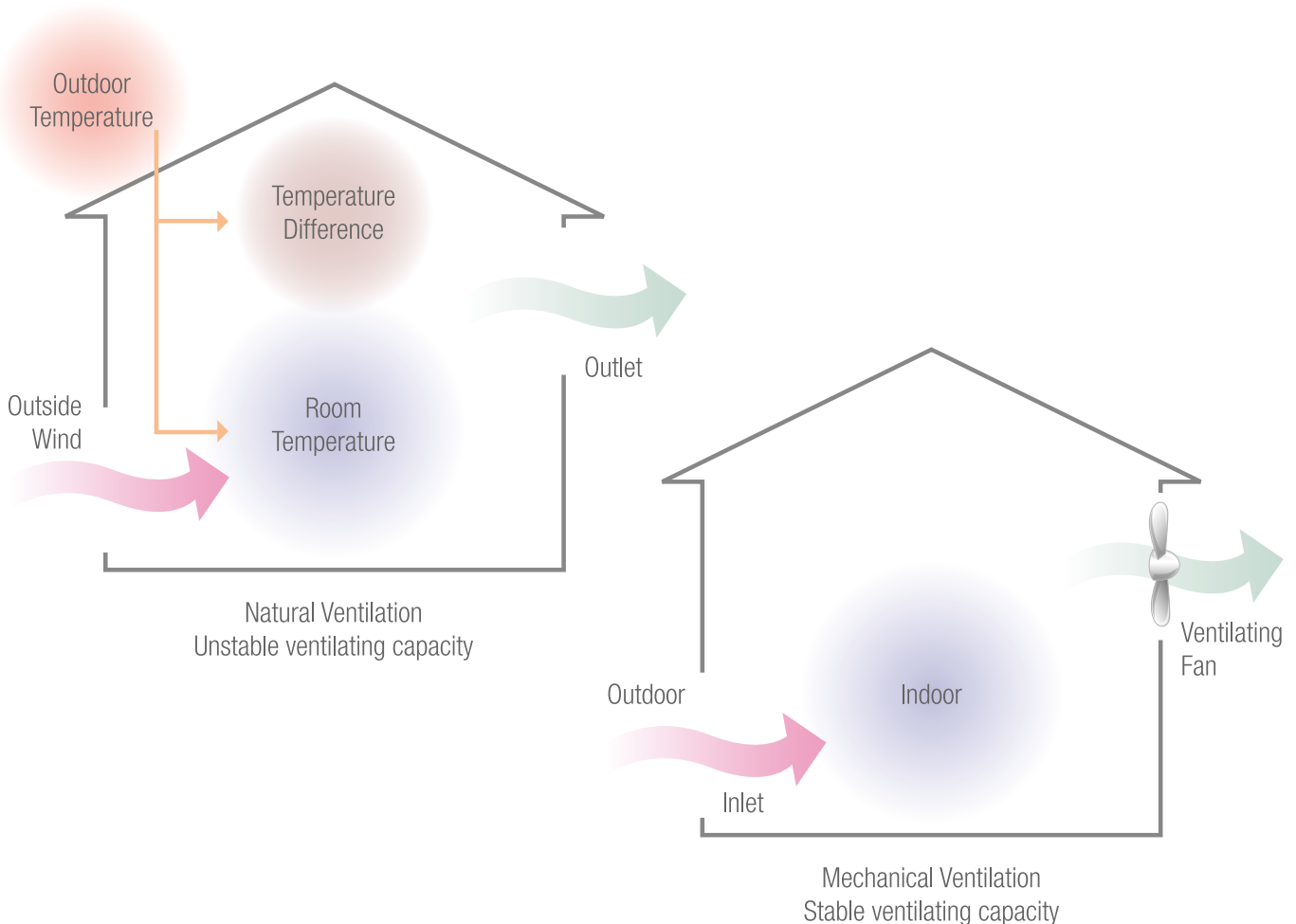

Auto Fan

360° Oscillation Fan



KQ409

Features

- 360° oscillation
- Easy adjustment angle 15°, 30° and 50°
- Condenser motor with ball bearing
- 5 speed electronic regulator

Specifications

Model	Color	Dimension	Energy Star Rating	RPM		Air Delivery (m ³ /min)	Motor W		Motor HP	Motor Type	Noise Level (dB)	Nett Weight (kg)
				Low	High		Low	High				
KQ409	White	16" / 40cm	5	568-694	1089-1331	85	18.3-22.4	46.8-57.2	0.08	14 Pole Condenser	<60	3.90



Features

- Improved high performance condenser motor with long life bearing
- Advanced blade design for high air volume and low noise level
- Low power consumption
- Strengthen Shutter Structure for better durability
- Installed directly into the glass window (window panel thickness from 3mm-7mm)
- Cord operated shutter

Specifications

Model	Dimension	RPM	CFM	Motor Rating	Motor W	Motor Type	Noise Level (dB)	Nett Weight (kg)
15WUD	6"/15cm	1463	124	220-240V, 50Hz	8	Condenser	35	0.90
20WUD	8"/20cm	1042	212		16		32	1.10

Dimensions (mm)

Model	A	B	C	D	E	F	G	H
15WUD	ø 150	ø 210	97	43	54	37.4	177	149
20WUD	ø 200	ø 271	98	36	62	36	237	201

Dimension

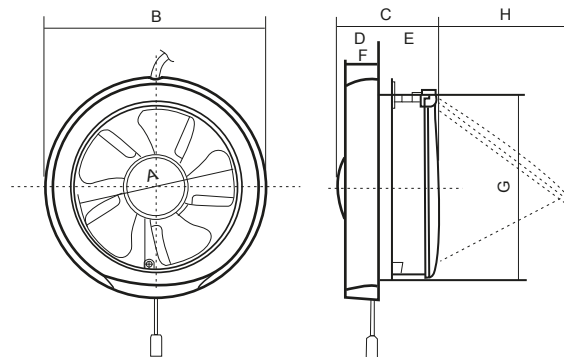

17 Wall Mounted Ventilating Fans



15AAQ1



20AQM8 • 25AQM7 • 30AQM8

Features

- Quiet operation
- High efficiency for air flow and energy saving
- Ball bearing motor for smooth rotation and excellent durability
- Automatic shutter
- Excellent for small room
(Applicable to 15AAQ1)

Specifications

Model	Dimension	RPM	CFM	Motor Rating	Motor W	Motor HP	Motor Type	Noise Level (dB)	Nett Weight (kg)
15AAQ1	6" / 15cm	1480	170	220-240V, 50Hz	15	-	Condenser	31	1.40
20AQM8	8" / 20cm	1109-1301	318		14.9-18.3	0.02	4 Pole Condenser	37	2.30
25AQM7	10" / 25cm	999-1221	530		25.2-30.8	0.03		39	2.60
30AQM8	12" / 30cm	925-1085	727		31.8-38.8	0.05		45	3.00

Dimensions (mm)

Model	A	B	C	D	E	F	G	H	I	J	K
15AAQ1	150 dia.	240	195	254	170	75	55	54	52	-	-
20AQM8	200 dia.	300	310	160	150	260	240	83	45	68	140
25AQM7	250 dia.	350	360	185	175	310	290	65	40	48	150
30AQM8	300 dia.	400	410	210	200	360	340	81			160

Dimensions

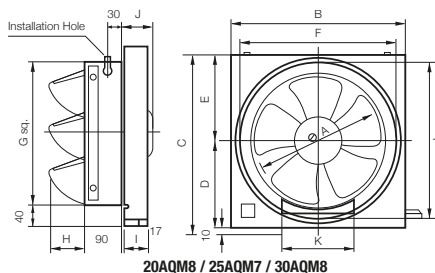
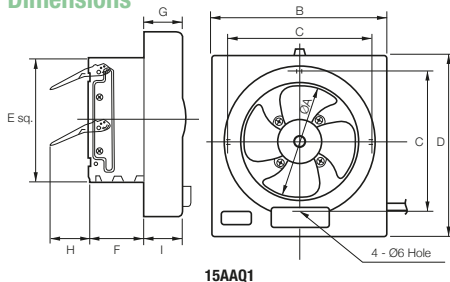



20ALH • 25ALH



Raku Raku (25AUFA)

Features

- Curve shape front louver design for better outlook and safety
- Advance aerodynamic blade design minimizes any obstacle against the airflow
- Improved high performance condenser motor with long life bearing
- Energy saving
- Automatic shutter
- Aluminium punching filter with non-stick coating provides easy maintenance (Applicable to 25AUFA)
- Oil deposition. Oil indicator on oil container shows deposited oil in level (Applicable to 25AUFA)

Specifications

Model	Dimension	RPM	CFM	Motor Rating	Motor W	Motor Type	Noise Level (dB)	Nett Weight (kg)
20ALH	8" / 20cm	1210	321	220-240V, 50Hz	22	Condenser	40	2.20
25ALH	10" / 25cm	1055	491		29		43	2.70
25AUFA	10" / 25cm	1100			34	HP	42	2.80

Dimensions (mm)

Model	A	B	C	D	E	F	G	H
20ALH	200	306	260	302	240	88	90	80
25ALH	250	356	310	352	290	68	90	63
25AUFA	250	371	352	150	290	70	90	65

Dimensions

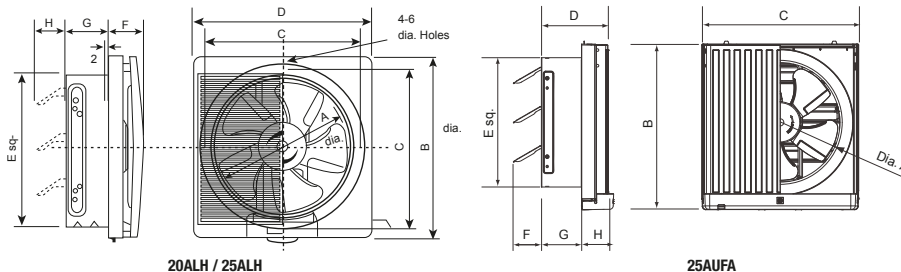

19 Wall Mounted Ventilating Fans



En 缘 10EGKA
Zen 禅 15EGKA

Accessories Included

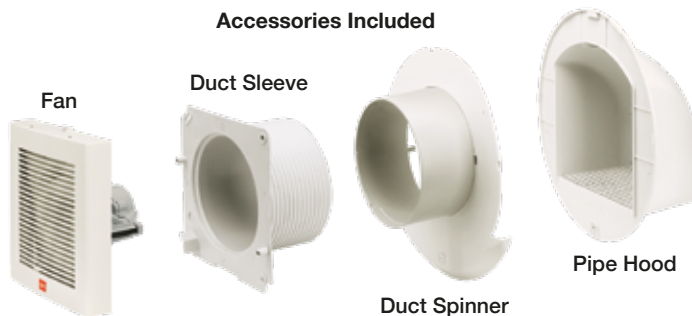

Features

- Excellent for bathroom use
- Easy installation
- Equipped with full accessories
- Easy cleaning
- Energy saving
- Exhaust moisture and odour, preventing mould

Specifications

Model	Dimension	RPM	CFM	Motor Rating	Motor W	Motor Type	Noise Level (dB)	Nett Weight (kg)
10EGKA	4" / 10cm	2732	45	220-240V, 50Hz	6.4	Capacitor Start,	33	1.20
15EGKA	6" / 15cm	2405	96		6.9	Run Induction Motor	35	1.50

Dimensions (mm)

Model	A	B	C	D	E	F	G	H	I	J	K	L	M	N	Installation Space
10EGKA	170	170	6	30	93	250	107	220	99	83	ø 120	ø 177	100	6 X 9.3	135 ± 5
15EGKA	220	220				310	142	270	138		ø 165	ø 221		6 X 11.5	180 ± 5

Dimensions

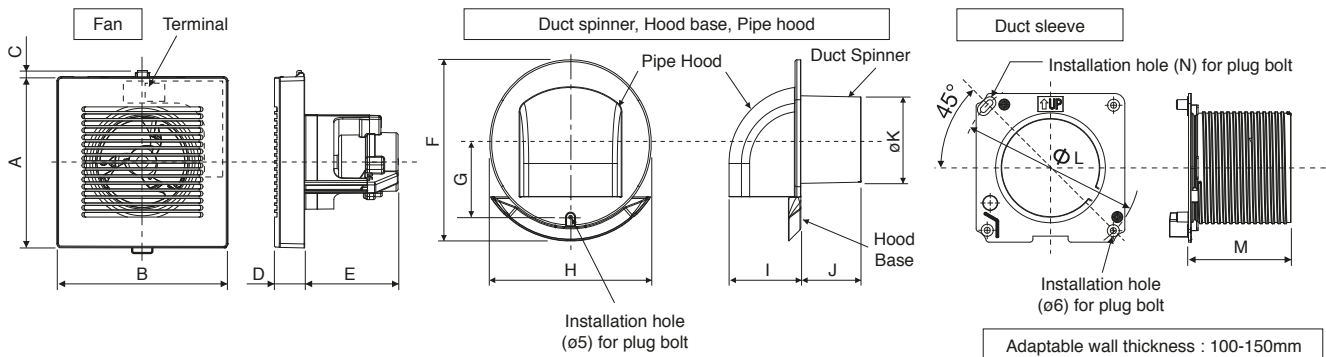



Features

- Q-Blade design for perfect balance and quiet operation
- High efficiency for air flow and energy saving
- Ball bearing motor for smoother and durable operation
- Suitable for commercial and residential use

Specifications

Model	Dimension	RPM	CFM	Motor Rating	Motor W	Motor HP	Motor Type	Noise Level (dB)	Nett Weight (kg)
15TGQZ	6" / 15cm	1330	141	220-240V, 50Hz	12	-	Condenser	35	1.20
20CQT1	8" / 20cm	1207	265		25.7	-	Condenser	41	1.80
25TGQ7	10" / 25cm	959-1172	367		24.8-30.3	0.03	4 Pole Condenser	45	1.90

Dimensions (mm)

Model	A	B	C	D	E	F	G	H
15TGQZ	244	230	244	230	18	108	253	214
20CQT1	315	305	286	128	260	223	200	18
25TGQ7	250	355	336	177.5	365	272	310	117.5

Dimensions

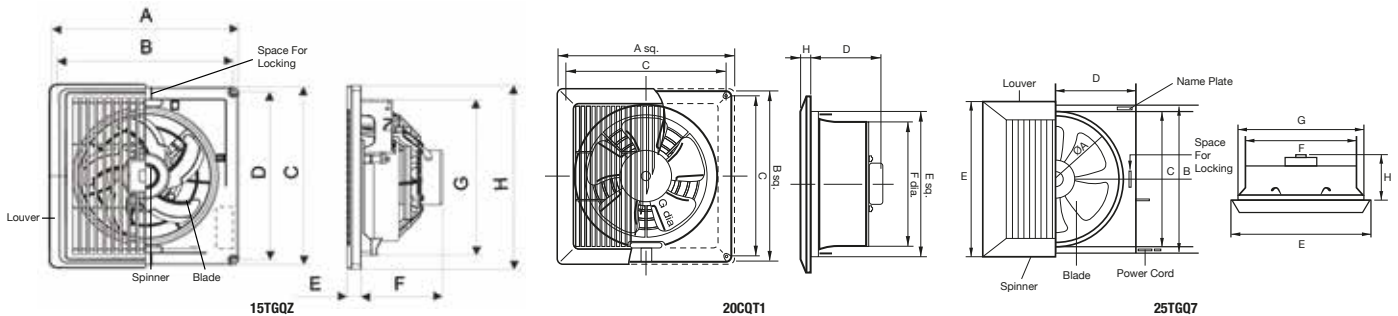

21 Ceiling Mounted Sirocco Ventilating Fans



17CUF • 24CUF • 24CDF • 24CHF

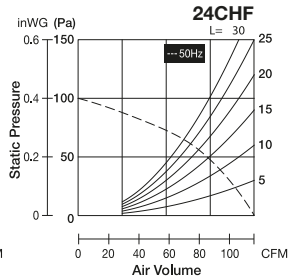
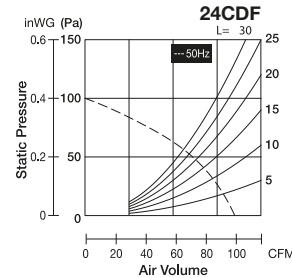
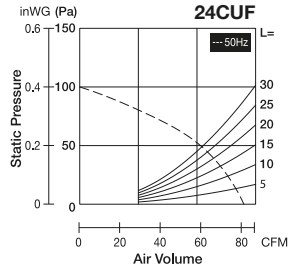
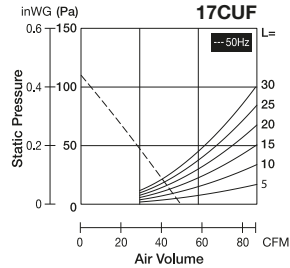

L : The length of duct (m) (The diameter of duct : Ø100mm)

Features

- Low noise with the distinctive design of Resonance-Noise-Absorption structure
- Taper blade design to achieve strong and smooth ventilating performance
- Better durability with well lubricated ball bearing type motor
- Reverse flow prevention shutter (shutter deflection if slight, resulting in further improvement of air tightness)

Specifications

Model	RPM	CFM	Motor Rating	Motor W	Motor Type	Noise Level (dB)	Nett Weight (kg)
17CUF	790	50	220-240V 50Hz	11	2 Pole Condenser	26	1.90
24CUF	690	82		14		28	2.90
24CDF	790	100		17	4 Pole Condenser	31	3.00
24CHF	870	118		20		35	3.00

Dimensions (mm)

Model	A	B	C	D	E	F	G	H	I	J	K	L	M	Installation Space	Applicable Pipe
17CUF	194	194	84	184	108	170	214	20	240	85	10	84	98	177 x 177	Ø 100
24CUF	254	255	140	200	110	230	278	13	300	85	10	90	98	240 x 240	Ø 100
24CDF															
24CHF															

Dimensions

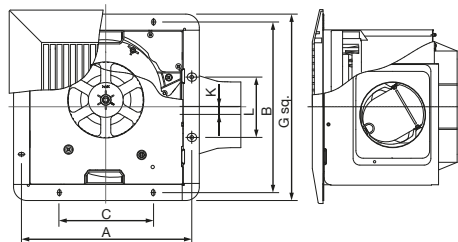
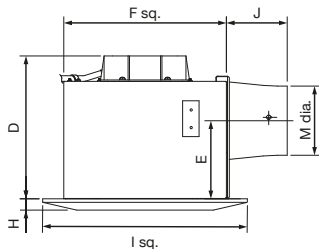



27CHH • 32CDH • 38CDG • 38CHG

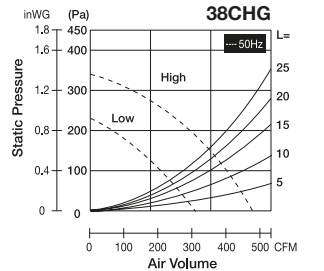
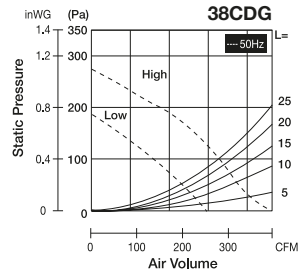
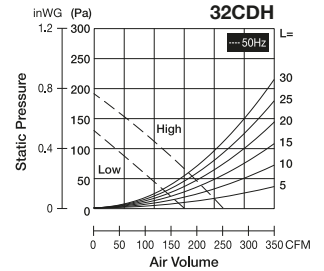
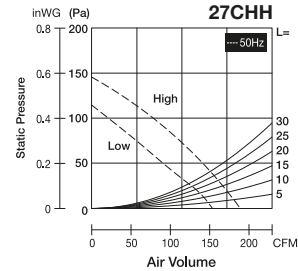

L : The length of duct (m) (The diameter of duct : Ø150mm)

Features

- Low noise with the distinctive design of Resonance-Noise-Absorption structure
- Taper blade design to achieve strong and smooth ventilating performance
- Better durability with well lubricated ball bearing type motor
- Reverse flow prevention shutter (shutter deflection if slight, resulting in further improvement of air tightness)
- 2 speed motor for better convenience

Specifications

Model		RPM	CFM	Motor Rating	Motor W	Motor Type	Noise Level (dB)	Net Weight (kg)	
27CHH	High	570	194	220 - 240V 50Hz	28	4 Pole Condenser	34	4.40	
	Low	480	153		23		30		
32CDH	High	590	253		42		36		5.20
	Low	460	177		32		28		
38CDG	High	645	377		90		44	9.70	
	Low	456	253		66		35		
38CHG	High	790	471		122		50	10.40	
	Low	540	309		89		40		

Dimensions (mm)

Model	A	B	C	D	E	F	G	H	I	J	K	L	M	N	O	P	Installation Space	Applicable Pipe
27CHH	307	284	140	240	112	260	307	19	330	100	43	70	148	100	-	112	270 x 270	Ø 150
32CDH	357	334	190	240	112	310	357	19	380	100	68	70	148	100	-	112	320 x 320	Ø 150
38CDG 38CHG	422	399	375	255	255	374	72.3	142	158	376	450	250	22	108	55	127	385 x 385	Ø 150

Dimensions

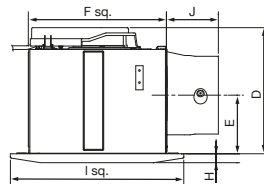
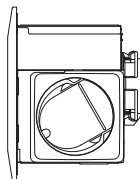
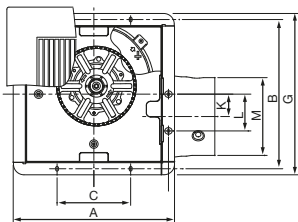

27CHH • 32CDH

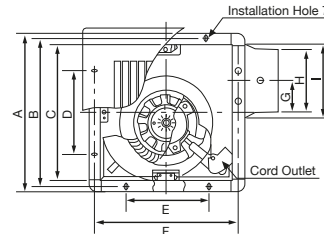

38CDG • 38CHG

23 Ceiling Mounted Sirocco Ventilating Fans



17CFM • 24CFM

Features

- Stylish front louver design
- Taper blade design to achieve strong and smooth ventilating performance
- Better durability with well lubricated ball bearing type motor
- Reverse flow prevention shutter (shutter deflection if slight, resulting in further improvement of air tightness)

Dimensions

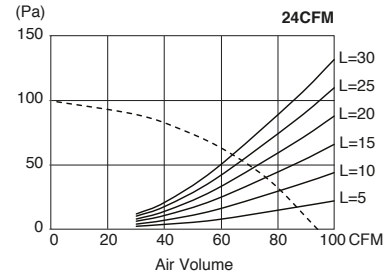
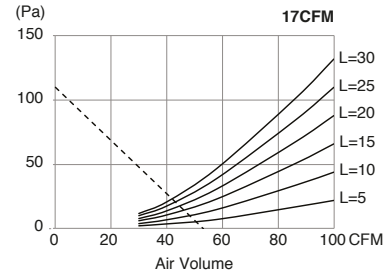
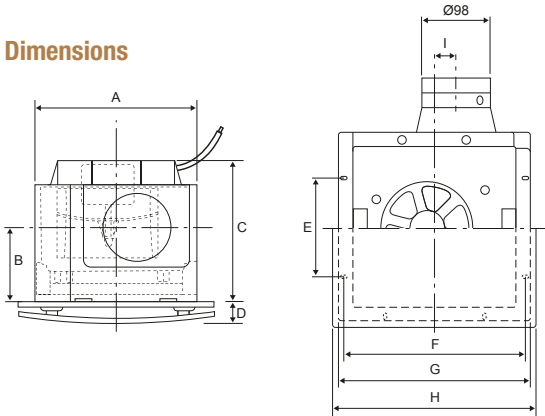

Specifications

Model	RPM	CFM	Motor Rating	Motor W	Motor Type	Noise Level (dB)	Nett Weight (kg)
17CFM	900	53	220-240V, 50Hz	13	2 Pole Condenser	29	2.00
24CFM	790	94	220-240V, 50Hz	17	4 Pole Condenser	31	3.20

Dimensions (mm)

Model	A	B	C	D	E	F	G	H	I	Installation Space	Applicable Pipe
17CFM	170	108	184	34	84	194	214	230	10	177 x 177	Ø 100
24CFM	230	110	200	38	140	255	278	290	10	240 x 240	Ø 100

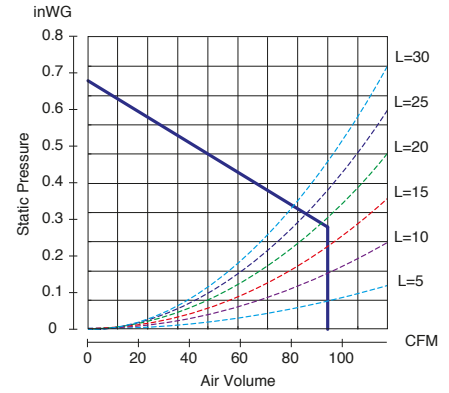

24JRB

Features

- **DC (Direct Current)** motor – Energy Saving
- Auto operation by Motion Sensor activated
- Constant airflow for 24-hour ventilating plan
- Variable speed selection
- Low noise with the distinctive design of Resonance-Noise-Absorption structure
- Taper blade design for strong and smooth performance
- Equipped with 15 minute delay timer

Specifications

Model	RPM	CFM	Motor Rating	Motor W	Motor Type	Noise Level (dB)	Nett Weight (kg)
24JRB	794	94	220-240V, 50Hz	8	DC	31	2.90

Dimensions (mm)

Model	A	B	C	D	E	F	G	H	I	J	K	L	Installation Space	Applicable Pipe
24JRB	278	255	140	180	339	230	12	300	94	100	98	45	240 x 240	Ø 100

Dimensions

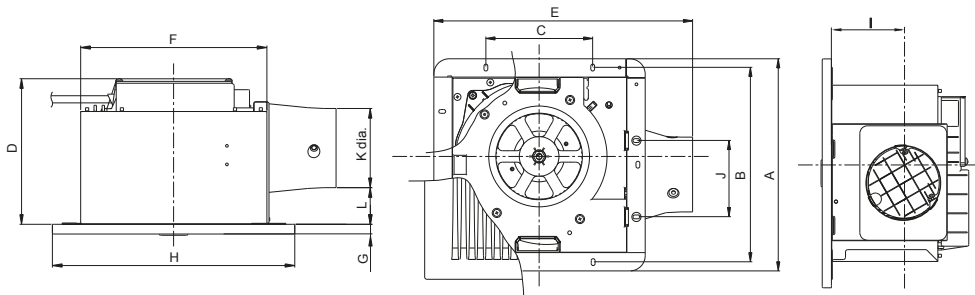

25 Industrial Ventilating Fans



30KQT • 40KQT



50AEQ2

Features

- To ventilate factories, warehouse, restaurant kitchen and other locations where powerful ventilation is necessary
- Large metal blade assembly for abundant air volume
- Powerful, efficient and durable condenser motor
- Can be used over an ambient temperature range of -10°C to +50°C
- Possible to install horizontally
- Equipped with automatic shutter

Specifications

Model	Dimension	RPM	CFM	Motor Rating	Motor W	Motor Type	Noise Level (dB)	Nett Weight (kg)
30KQT	12" / 30cm	1185	718	220-240V, 50Hz	42	4 Pole Condenser	46	4.90
40KQT	16" / 40cm	1175	1212		61		49	6.40
50AEQ2	20" / 50cm	920	2136		108	4 Pole Induction	54	11.50

Dimensions (mm)

Model	A	B	C	D	E	F	G	H	I	J	K	L	M
30KQT	307	420	385	420	385	164	34	40	116	340	90	141	10
40KQT	410	510	480	510	480	181	40	52	133	434	90	141	10
50AEQ2	500	650	600	650	600	331	48	63	181	526	175	-	12

Dimensions

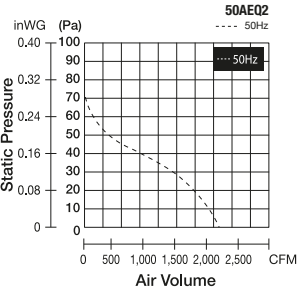
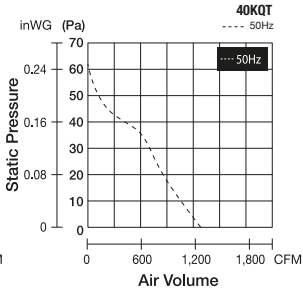
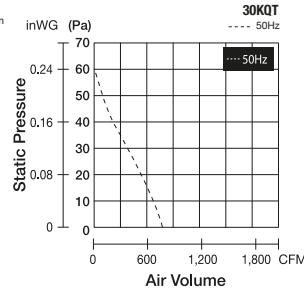
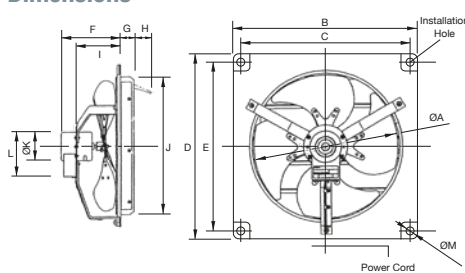



25GSC • 30GSC • 35GSC

Features

- Single Phase (Reversible)
- Slimline design for optimum space utilization, permitting installation in equipment
- A unique drain mechanism discourages the ingress of water and dust into the motor, resulting in excellent durability
- The high-performance totally enclosed condenser motor contains a thermal protector which prevents the temperature of the motor from rising abnormally
- Can be used over an ambient temperature range of -10°C to + 50°C
- Possible to install horizontally
- Optional shutter available (Refer page 36)

Specifications

Model	Dimension	RPM	CFM	Motor Rating	Motor W	Motor Type	Noise Level (dB)	Nett Weight (kg)
25GSC	10" / 25cm	1360	676	240V, 50Hz	39	4 Pole Induction	34	4.40
30GSC	12" / 30cm	1360	1071		59		38	6.10
35GSC	14" / 35cm	1420	1507		88		44	10.50

Dimensions (mm)

Model	A	B	C	D	E	F	G
25GSC	250 dia.	327	298	165	171	164	10 dia.
30GSC	300 dia.	378	349	210	200	187	
35GSC	350 dia.	467	434	250	236	219	12 dia.

Dimensions

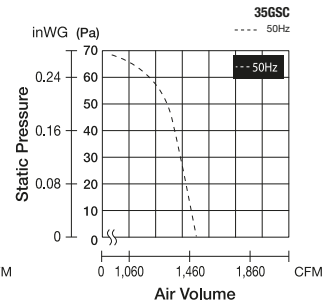
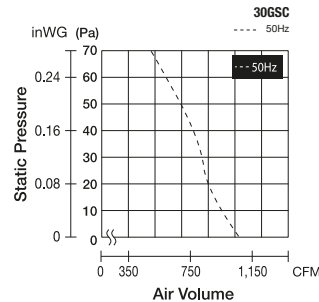
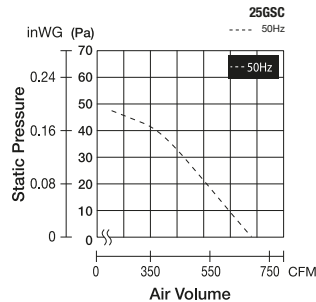
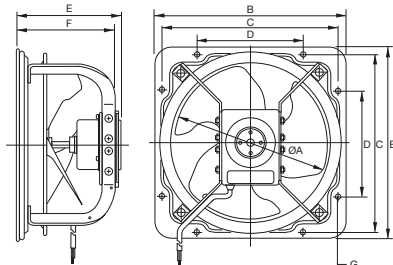

27 High Pressure Industrial Ventilating Fans



40GSC • 45GSC • 50GSC • 60GSC

Specifications

Model	Dimension	RPM	CFM	Motor Rating	Motor W	Motor Type	Noise Level (dB)	Nett Weight (kg)
40GSC	16" / 40cm	1450	2125	240V, 50Hz	161	4 Pole Induction	47	19.00
45GSC	18" / 45cm	1410	3061		227		51	19.00
50GSC	20" / 50cm	960	3608		249	6 Pole Induction	47	22.50
60GSC	24" / 60cm	970	4732		245		50	34.00

Dimensions (mm)

Model	A	B	C	D	E	F	G	H
40GSC	400 dia.	518	485	460	280	274	225	12 dia.
45GSC	450 dia.	570	540	-	320	297	248	
50GSC	500 dia.	659	620	560	355	315	266	15 dia.
60GSC	620 dia.	760	720	650	400	320	262	

Features

- Single Phase (Reversible)
- Slimline design for optimum space utilization, permitting installation in equipment
- A unique drain mechanism discourages the ingress of water and dust into the motor, resulting in excellent durability
- The high-performance totally enclosed condenser motor contains a thermal protector which prevents the temperature of the motor from rising abnormally
- Can be used over an ambient temperature range of -10°C to + 50°C
- Possible to install horizontally
- Optional shutter available (Refer page 36)

Dimensions

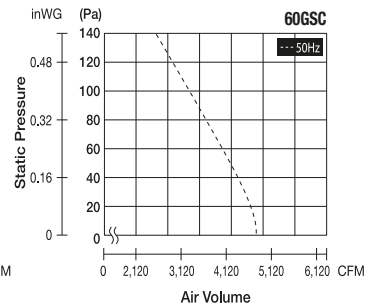
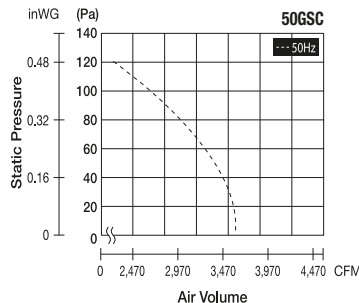
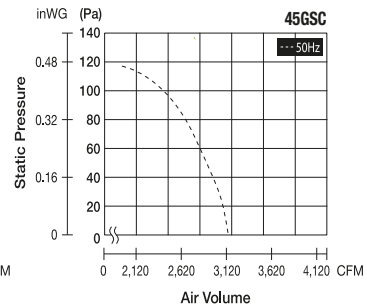
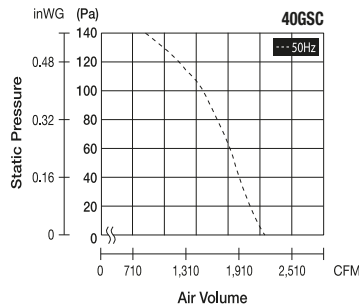
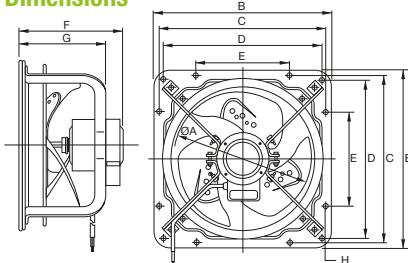



45GTC • 50GTC • 60GTC

Specifications

Model	Dimension	RPM	CFM	Motor Rating	Motor W	Motor Type	Noise Level (dB)	Nett Weight (kg)
45GTC	18" / 45cm	1450	3249	415V, 50Hz	220	4 Pole Induction	52	18.50
50GTC	20" / 50cm	1400	4097		320		54	28.50
60GTC	24" / 60cm	940	5544		310	6 Pole Induction	49	34.00

Dimensions (mm)

Model	A	B	C	D	E	F	G	G
45GTC	450 dia.	570	540	-	320	297	248	12 dia.
50GTC	500 dia.	659	620	560	355	304	246	15 dia.
60GTC	620 dia.	760	720	650	400	320	262	

Features

- Three Phase (Reversible)
- Slimline design for optimum space utilization, permitting installation in equipment
- A unique drain mechanism discourages the ingress of water and dust into the motor, resulting in excellent durability
- The high-performance totally enclosed condenser motor contains a thermal protector which prevents the temperature of the motor from rising abnormally
- Can be used over an ambient temperature range of -10°C to + 50°C
- Possible to install horizontally
- Optional shutter available (Refer page 36)

Dimensions

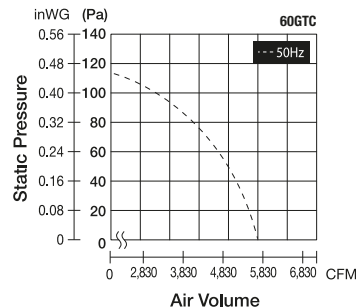
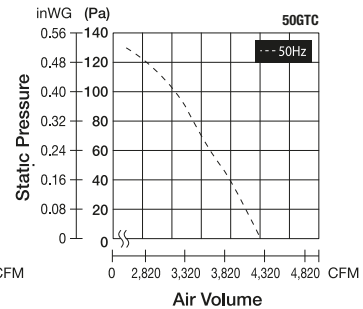
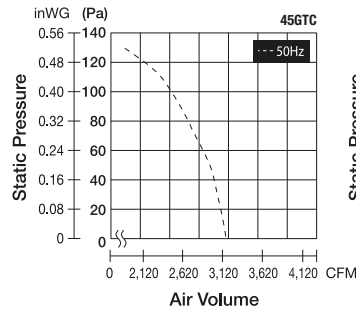
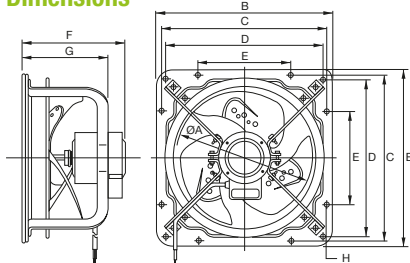

29 Industrial Wall Fans



K50RA

Features

- Oscillation control and easy angle adjustment
- Safety mesh wire guard
- 3-speed and off by push button switch (Wall Mounted)

Specifications

Model	Dimension	Air Velocity (ft/min)	CFM	Motor W	Nett Weight (kg)	Noise Level (dB)	
K50RA	20" / 50cm	High	1043	6710	146	13.10	62
		Medium	925	5297	115		
		Low	826	4238	104		

Dimensions

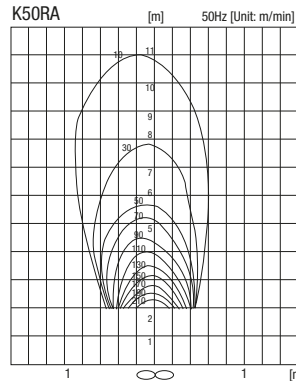
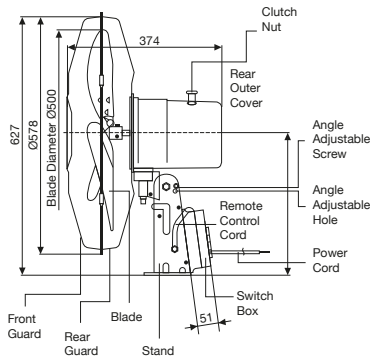
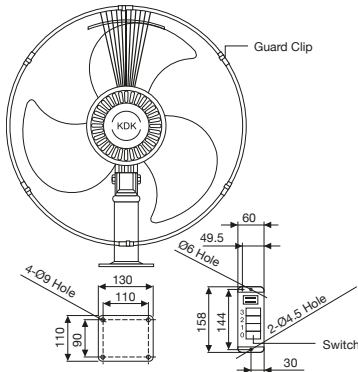



KU50Y

Features

- 3 speed **ON/OFF** pull switch
- Full automatic oscillation
- Aluminium blade for stronger airflow and durability
- **Turbo Fin Guard** design generates strong and focus airflow up to 10 meter distance
- **Front Guard Locking System** for safety purpose
- Added **angle adjust bolt** for extra stability on the fan's knee joint

Specifications

Model	Color	Dimension	RPM		CFM	Motor W		Motor HP	Motor Type	Noise Level (dB)	Nett Weight (kg)
			Low	High		Low	High				
KU50Y	White	20"/ 50cm	940	1280	3885	60	70	0.094	14 Pole Condenser	59	6.0



08ESK • 08ELK • 10ESK • 10ELK
12ESK • 12ELK • 14ESK • 14ELK

Features

- Unique sirocco fan provides an effective, amply-sized, powerful air door
- Simplified installation; either wall-hang, or suspended from the ceiling of a room
- Two-speed changeover (HI, LO and OFF) is available with a push-button switch provided in the unit
- Attractive modern design enhances installation placement in any location

Specifications

Model		Length (mm)	Current (A)	Outlet Velocity (m/s)	CFM	Motor W	Noise Level (dB)	Nett Weight (kg)
08ESK (3 x 8)	Hi	900	0.23	11.5	383	46	42	12.00
	Lo		0.21	10.3	341	42	39	
08ELK (4 x 8)	Hi	1200	0.28	11.6	518	57	43	14.00
	Lo		0.27	10.6	471	53	41	
10ESK (3 x 10)	Hi	900	0.4	13	441	72	46	12.00
	Lo		0.29	11.1	371	62	42	
10ELK (4 x 10)	Hi	1200	0.54	13.1	589	96	46	14.00
	Lo		0.35	11	489	74	42	
12ESK (3 x 12)	Hi	900	0.82	16.9	618	176	55	13.00
	Lo		0.69	15.8	565	155	50	
12ELK (4 x 12)	Hi	1200	1.04	17	836	224	56	15.00
	Lo		0.9	15.8	777	200	51	
14ESK (3 x 14)	Hi	900	1.14	21.9	789	257	62	13.00
	Lo		0.99	19.1	687	218	59	
14ELK (4 x 14)	Hi	1200	1.52	22.5	1099	333	63	15.00
	Lo		1.32	20.1	982	290	61	

Dimensions (mm)

Model	A	B	C	D	E	F	G	H
08ESK	900	50	400	120	63	205	226	250
08ELK	1200	200						
10ESK	900	50						
10ELK	1200	200						
12ESK	900	50						
12ELK	1200	200						
14ESK	900	50						
14ELK	1200	200						

Dimensions

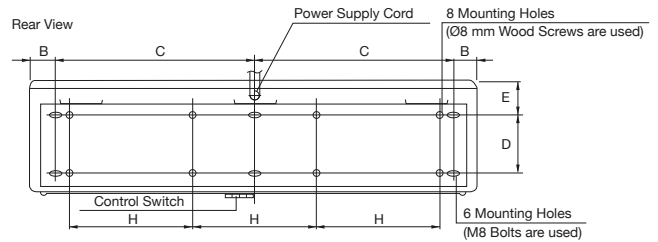
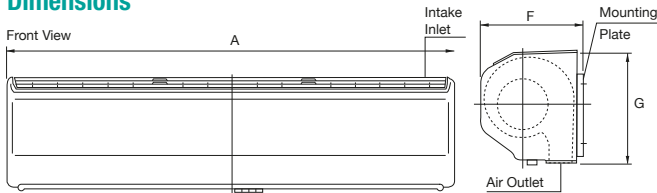

Efficient distance	Air velocity chart (m/s) Maximum value at HI speed 50Hz	Length of unit	
		900mm (3 feet)	1200mm (4 feet)
2.5m (8 feet)		08ESK	08ELK
3.0m (10 feet)		10ESK	10ELK

Efficient distance	Air velocity chart (m/s) Maximum value at HI speed 50Hz	Length of unit	
		900mm (3 feet)	1200mm (4 feet)
3.5m (12 feet)		12ESK	12ELK
4.0m (14 feet)		14ESK	14ELK

33 Mini Sirocco Fans



K10CG1 • K12CG1 • K14CG1 • K16CG1
K17CG1 • K19CG1 • K21CG1

Features

- New concept body design
- High performance sirocco fan with low noise level
- Duct size at both suction and discharge port are identical to improve stability
- Outlet direction is adjustable to vertical or horizontal position

Specifications

	Model No.	Input (W)	Fan Speed (min ⁻¹)	CFM	NOISE (dB)			Impeller Diameter (cm)	Suction Duct Size (mm)	Discharge Duct Size (mm)	Nett Weight (kg)	
					Casing Side	Suction Side	Discharge Side					
Single Phase	K10CG1	11	980	85	32	38	38	10	ø100	ø100	3.10	
	K12CG1	21	760	152	34	39	39	12	ø150	ø150	3.60	
	K14CG1	30	930	181	39	44.5	44.5	12	ø150	ø150	3.80	
	K16CG1	Hi	49	1080	291	43.5	50	50	15	ø150	ø150	5.30
		Lo	41	875	215	38	44.5	44.5				
	K17CG1	Hi	87	920	443	46	51	51	18	ø200	ø200	8.80
		Lo	74	815	377	42.5	47	47				
	K19CG1	Hi	117	1110	557	50.5	55.5	55.5	18	ø200	ø200	9.40
		Lo	109	1030	483	49	54	54				
	K21CG1	Hi	240	1325	836	57	61	61	20	ø200	ø200	15.00
Lo		220	1230	742	56	59.5	59.5					

Dimensions (mm)

Model	A	B	C	D	E	F	G	H	I	J	K	L	M	N	O	P
K10CG1	206	86	95	24	180	56	82	199	98	199	80	74	106	120	98	-
K12CG1	261	112	119	29	230	76	100	261	148	230	105	98	131	145	148	-
K14CG1																
K16CG1	281	125	126	250	160	85	108	279	148	237	117	102	143	157	128	148
K17CG1	331	151	150	300	160	106	130	346	198	310	165	116	187	205	142	198
K19CG1																
K21CG1	361	166	165	330	200	121	145	378	198	360	190	110	226	250	161	198

Dimensions

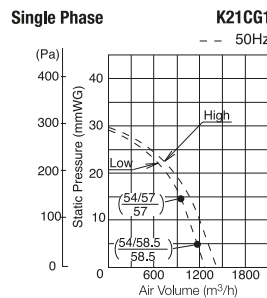
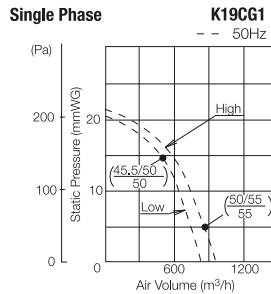
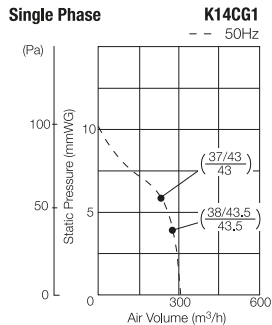
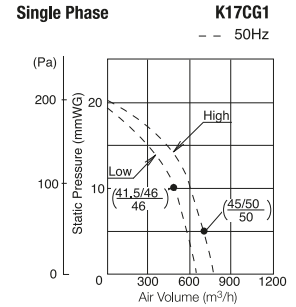
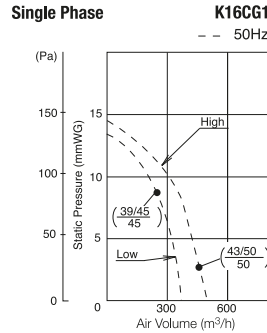
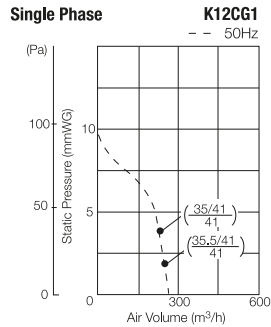
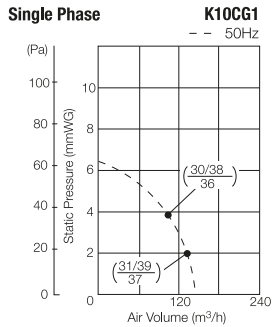
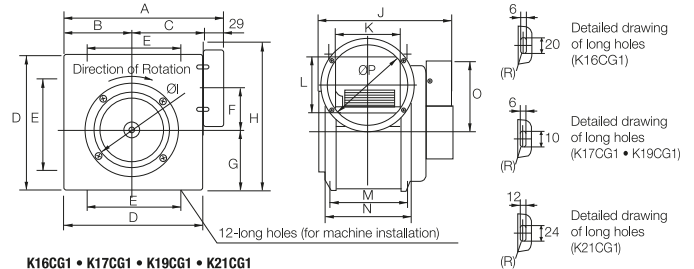
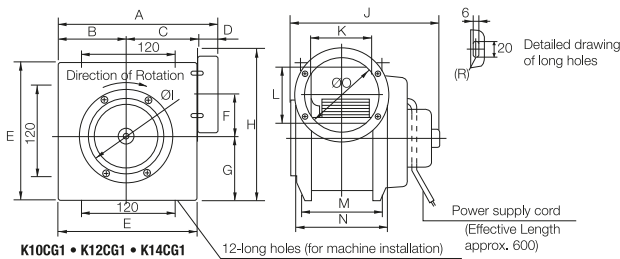



Duct Cover For Ventilating Fan

- High Strength - SUS 304 stainless steel
- Excellent anti-rust capability - hood part coated with metallic silver paint.
- Easy Installation - spring clips facilitate duct / pipe connection
- Keep out ingress of small particles and insects from outside

Specifications

Model	A	B	C	D	E	Dimension of Net (mm)	Dimension of Applicable Pipe (mm)*
MGX100K	141	79	20	97	48	2.5 x 2.5	100
MGX150K	190	106	23	147	53	2.5 x 2.5	150

* Applicable models
 100mm = 17CUF, 24CUF, 24CDF, 24CHF, 24JRB, 17CFM, 24CFM
 150mm = 27CHH, 32CDH, 38CDG, 38CHG

Dimension

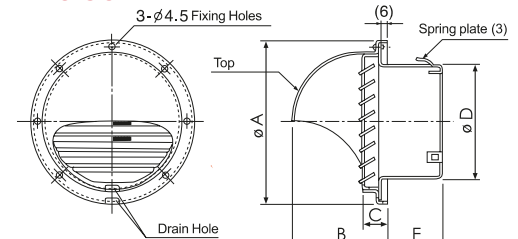

Extended Fork Pipe for Ceiling Fan

- Equipped with full length safety wire with switch lever for safety switch
- Available upon ordering (one month lead time)
- Available in various length

Specifications (Applicable to K12V0, K15V0 & K15W0-S)

Part Number	Description
M15A00292ZMW	Pipe Assy (30cm / 12")
SPCF2001-M	Pipe Assy (40cm / 16")
SPCF2002-M	Pipe Assy (45cm / 18")
SPCF2003-M	Pipe Assy (60cm / 24")
SPCF2004-M	Pipe Assy (75cm / 30")
SPCF2005-M	Pipe Assy (90cm / 36")
SPCF2007-M	Pipe Assy (120cm / 48")
SPCF2008-M	Pipe Assy (135cm / 54")
SPCF2009-M	Pipe Assy (150cm / 60")

Specifications (Applicable to K18NY Only)

Part Number	Description
KZ30PB	Pipe Assy (75cm / 30")
KZ36PB	Pipe Assy (90cm / 36")
KZ48PB	Pipe Assy (120cm / 48")
KZ60PB	Pipe Assy (150cm / 60")
KZ79PB	Pipe Assy (197.5cm / 79")



Shutter for High Pressure Ventilating Fan

(Applicable to 25GSC, 30GSC, 35GSC, 40GSC, 45GSC, 50GSC, 60GSC, 45GTC, 50GTC, 60GTC)

- Available upon ordering (3-4 months lead time)

Specifications

Model	Size	Dimension (mm)										No of Shutter
		A	B	C	D	E	F	G	H	I	J	
25GASC	25cm/ 10"	330	303	298	268	263	165	268	137	10	6	2
30GASC	30cm/ 12"	381	354	349	319	314	210	319	122	10	6	3
35GASC	35cm/ 14"	468	433	434	389	384	250	389	137	12	6	3
40GASC	40cm/ 16"	519	484	485	440	435	280	440	122	12	6	4
45GASC	45cm/ 18"	574	539	540	492	487	320	492	137	15	5	5
50GASC	50cm/ 20"	660	625	620	545	540	355	545	122	15	5	5
60GASC	60cm/ 24"	760	725	720	662	657	400	662	122	15	5	6

Dimensions

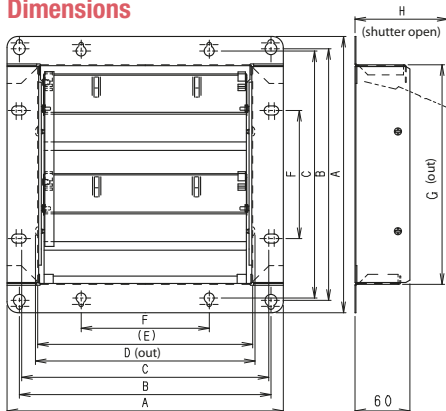

Fans For Life!



SINCE 1909
JAPAN

KDK FANS (M) SDN BHD (Company No: 568849-X)

3rd Floor, 15 Jalan Tandang, 46050 Petaling Jaya, Selangor.

Tel : 03-7785 5011

Fax : 03-7785 2655

Website: www.kdk.com.my

Printed in Malaysia **CATALOG NO : ME-19-A**

02.19

Specifications are subject to change without prior notice

** Product colours may vary from pictures shown